

In the Garden...

Write down every color you can find in our garden!

This flower looks like a Chinese lantern when it's closed and like a star when it blooms. In what number beds can you find it? (check out the garden map →)

_____, _____, _____, and _____

This good smelling plant has a color named after it. It's in garden bed 4. Do you know its name?

In beds 4 and 7, you can find this plant that the bumble bees especially love. It has whitish leaves that have hairs. Try touching its leaves. How do they feel?

Birds, butterflies, and bees all love Hill-Stead's garden. One of our favorite visitors is a bird with a red breast. Can you find one? What is its name?

Hill-Stead in bloom!

Explore the Sunken Garden using all your senses, then answer the questions and sketch your favorite flower using the back of this page.

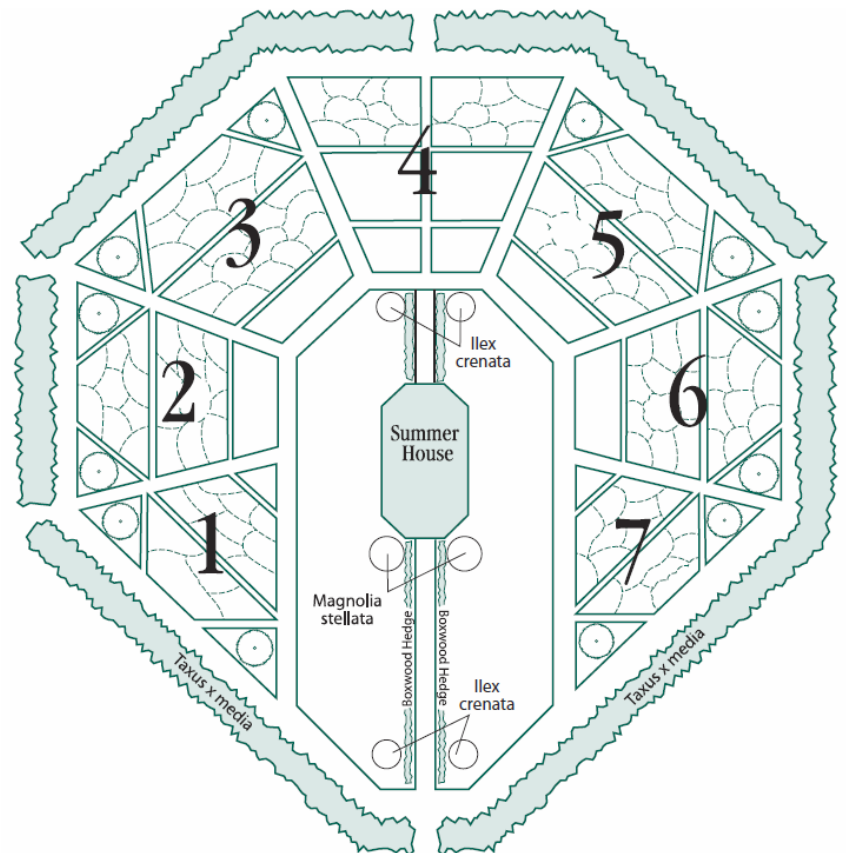

Hill-Stead in bloom!

Sketch your favorite flower or leaf here...